



General

The Explorer EXC3 series AC Contactor (hereinafter referred to as Contactor) is mainly used for circuit of AC 50Hz (or 60Hz), rated voltage up to 690V, and rated operating current up to 95A under the AC-3 usage category. It is mainly used for frequent start and control of AC motor, closing and breaking the circuit remotely, and can be assembled as an electromagnetic AC motor, closing and breaking the circuit remotely, and can be assembled as an electromagnetic starter with an appropriate thermal overload relay to protect the circuit from possible overload.

Conform to standard: GB/T 14048.1/IEC 60947-1、GB/T 14048.4/IEC 60947-4-1

Model Meaning

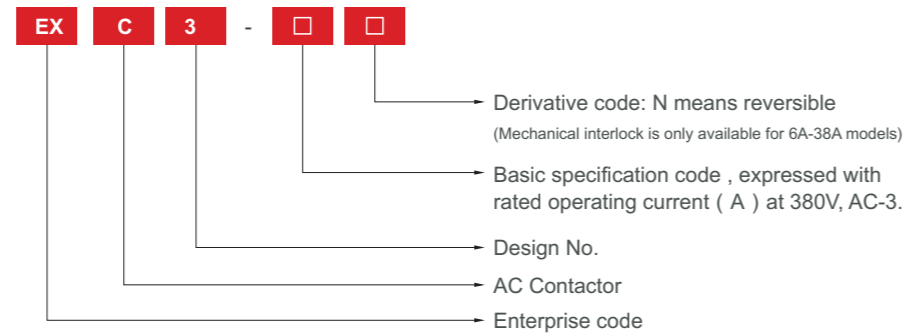

Operating Conditions

1. Ambient temperature: Limited temperature -5°C~ +70°C, Normally working temperature -5°C~ +40°C. Average value in 24 hours ≤ +35°C. It will be derated if temperature exceeds +40°C.
2. Altitude: ≤ 2000m
3. Atmospheric conditions: The relative humidity of the air does not exceed 50% at the temperature of +40°C. Higher relative humidity permitted at lower temperature, for example 90% relative humidity at 20°C. Special measures are necessary in case of occasional condensation due to variations in temperature.
4. Pollution degree: 3
5. Installation category: III
6. Protection degree: Ip20
7. Mounting conditions: The inclination of the mounting surface and the vertical is not more than ± 5°
8. Impact vibration: The contactor should be in the stable place without any shake, impact and vibration.
9. Transportation and storage: During transportation the contactor should not be subjected to severe collisions and vibrations, neither attacked by rain / snow in any time. Contactor is suitable for transportation and storage at temperatures range from -25°C ~ +55°C, can up to +70°C in a short time (within 24h).

Main Parameters and Performance

AC Contactor model	EXC3													
	06	09	12	18	25	32	38	40	50	65	80	95		
Main circuit characteristics														
Rated Insulation voltage Ui(V)	690													
Conventional thermal current Ith(A)	20			32	40	50		60	80		125			
Rated operating current Ie (A)	220V (230V)	AC-3	6	9	12	18	25	32	38	40	50	65	80	95
	380V (400V)	AC-3	6	9	12	18	25	32	38	40	50	65	80	95
		AC-4	2.6	3.5	5	7.7	8.5	12	14	18.5	24	28	37	44
	660V (690V)	AC-3	3.8	6.6	8.9	12	18	21	22	34	39	42	49	55
AC-4		1	1.5	2	3.8	4.4	7.5	8.9	9	12	14	17.3	21.3	
Controllable three-phase squirrel cage motor power Pe (AC-3) kW	220V	1.5	2.2	3	4	5.5	7.5	9	11	15	18.5	22	22	
	380V	2.2	4	5.5	7.5	11	15	18.5	18.5	22	30	37	45	
	660V	3	5.5	7.5	9	15	18.5	18.5	30	33	37	45	55	
Recommended fuse SCPD	RT16-00 16A	RT16-00 20A			RT16-00 32A	RT16-00 40A	RT16-00 50A	RT16-00 63A	RT16-00 63A	RT16-00 80A	RT16-00 80A	RT16-00 100A	RT16-00 125A	
Operating Frequency (Times/H)	AC-3	1200						600						
	AC-4	300												
Electrical life (1x10 ⁴ times)	AC-3	100						80				60		
	AC-4	20						15				10		
Mechanical life (1x10 ⁴ times)	1000						800							
Coil														
Rated control circuit voltage (US)	50Hz	24V、36V、110V、127V、220V、380V , For other specification please discuss with Huanyu												
Permissible control circuit voltage(US)	Operating	70% ~ 120%Us												
	Release	20% ~ 75%Us												
Coil power	Pull in VA	50 ~ 70						190 ~ 220						
	Hold on	7 ~ 11.4						19 ~ 25						
	Power consumption	1.8 ~ 4						6 ~ 10						
Terminal wiring capacity														
Flexible wire without terminal	1 PCS(mm ²)	1 ~ 4			1.5 ~ 10			2.5 ~ 25			4 ~ 50			
	2 PCS(mm ²)	1 ~ 4			1.5 ~ 6			2.5 ~ 16			4 ~ 25			
Flexible wire with terminal	1 PCS(mm ²)	1 ~ 4			1 ~ 6			2.5 ~ 25			4 ~ 50			
	2 PCS(mm ²)	1 ~ 2.5			1 ~ 4			2.5 ~ 10			4 ~ 16			
Hard wire without terminal	1 PCS(mm ²)	1 ~ 4			1.5 ~ 6			2.5 ~ 25			4 ~ 50			
	2 PCS(mm ²)	1 ~ 4			1.5 ~ 6			2.5 ~ 16			4 ~ 25			
Terminal screw specification		M3.5×9.5			M4×15.5			M8×16			M10×20			
Fastening Torque N·m		0.8			1.8			5			9			

EXC3-N Series Mechanical interlock contactor technical parameters and performance

Model	Ui (V)	Ith (A)	Ie @ AC-3 (A)		Pe @ AC-3 (kW)			Ie @ AC-4 (A)		Pe @ AC-4 (kW)	
			380V	660V	220V	380V	660V	380V	660V	380V	660V
EXC3-06N	690	20	6	3.8	1.5	2.2	3	2.6	1	1.1	0.75
EXC3-09N		20	9	6.6	2.2	4	5.5	3.5	1.5	1.5	1.1
EXC3-12N		20	12	8.9	3	5.5	7.5	5	2	2.2	1.5
EXC3-18N		32	18	12	4	7.5	9	7.7	3.8	2.2	1.5
EXC3-25N		40	25	18	5.5	11	15	8.5	4.4	4	4
EXC3-32N		50	32	21	7.5	15	18.5	12	7.5	5.5	5.5
EXC3-38N		50	38	22	9	18.5	18.5	14	8.9	5.5	6

AC Contactor accessories and mounting position

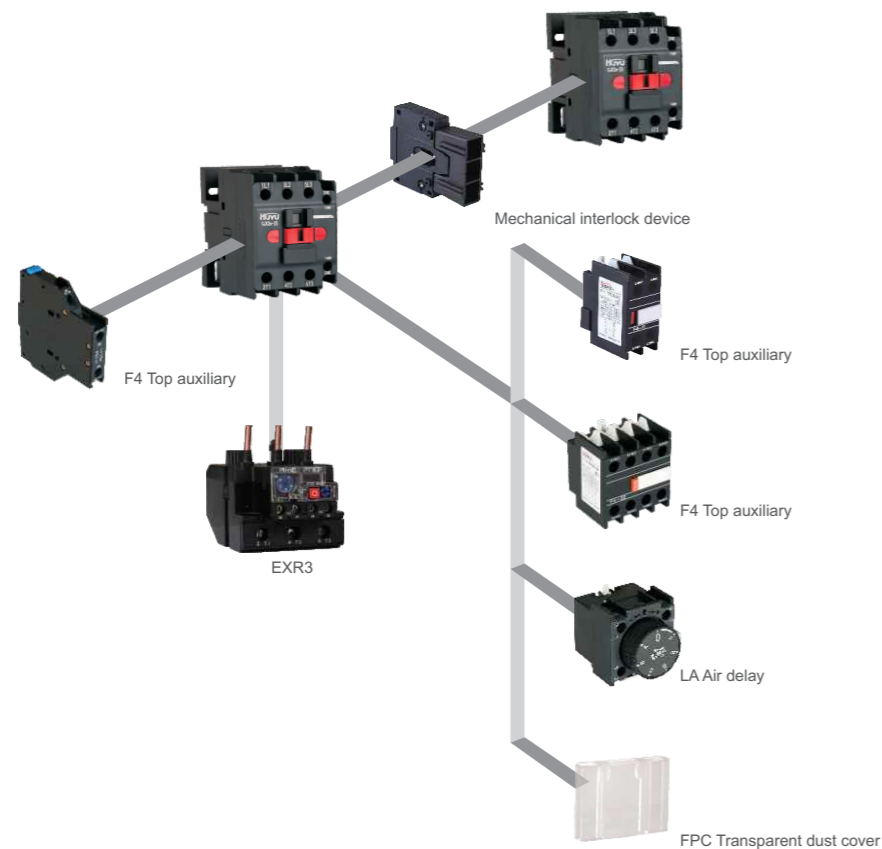

- 1.FPC Transparent dust cover
- 2.F4 top auxiliary contacts: The model has 2 contacts and 4 contacts choice
2 contacts choice: 2NO+0NC , 1NO+1NC , 0NO+2NC
4 contacts choice: 2NO+0NC , 1NO+1NC , 0NO+2NC
- 3.FC4 Side auxiliary contacts: 2 Contacts , choice of 2NO , 1NO+1NC , 2NC
- 4.LA series air delay : There are two selections of power-on delay LA2 and power-off delay LA3, 1NC+1NO contacts time adjustable range: 0.1~3s, 0.1~30s, 10~180s

Accessories main parameters and technical performance

1、Auxiliary contacts

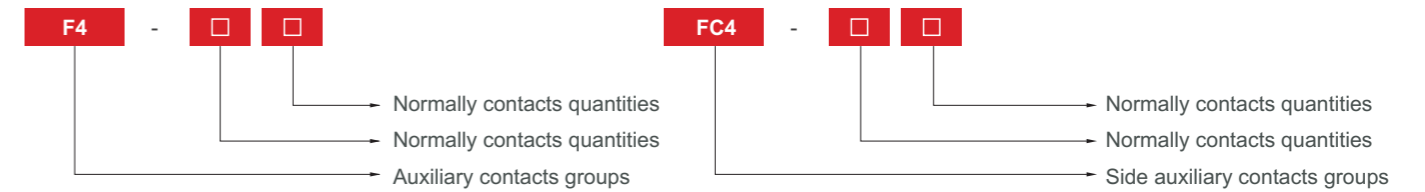

Auxiliary contacts model	F4-02	F4-11	F4-20	F4-22	F4-40	F4-04	F4-13	F4-31	FC4-02	FC4-11	FC4-20
Contacts quantities	2NC	1NO+1NC	2NO	2NO+2NC	4NO	4NC	1NO+3NC	3NO+1NC	2NC	1NO+1NC	2NO

Auxiliary contacts basic parameters

Usage category	Rated operating voltage(V)	Conventional thermal current(A)	Rated operating current(A)	Control capacity	
				Closing	Breaking
AC-15	380	10	0.95	3600VA	360VA
DC-13	220	10	0.15	33W	33W

2、Air delay

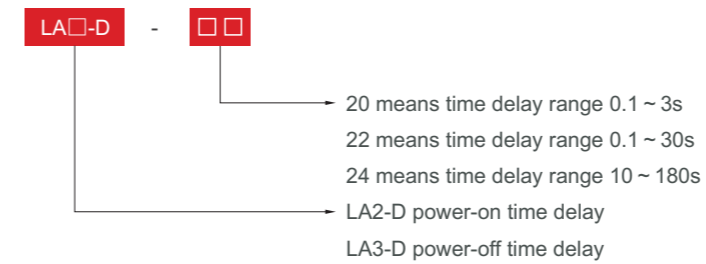

Model	Time delay range	Time delay contacts quantities
LA2-D20	0.1 ~ 3s	1NO+1NC
LA2-D22	0.1 ~ 30s	
LA2-D24	10 ~ 180s	
LA3-D20	0.1 ~ 3s	
LA3-D22	0.1 ~ 30s	
LA3-D24	10 ~ 180s	

Air delay basic parameters

Usage category	Rated operating voltage(V)	Rated Insulation voltage Ui(V)	Conventional thermal current(A)	Control capacity
AC-15	Up to 660	660	10	360VA
DC-13	Up to 660	660	10	33W

3、FPC Transparent dust cover

Model FPC, universal to the whole series.

4、The contactor pull-in coil power consumption and energy efficiency index

Model	EXC3-06 ~ 18	EXC3-25 ~ 38	EXC3-40 ~ 95	Remark
Holding power/VA	9.0	11.4	36.6	Conformity to GB 21518-2008
Energy Efficiency Index	3	2	2	Conformity to GB 21518-2008

Wiring Diagram

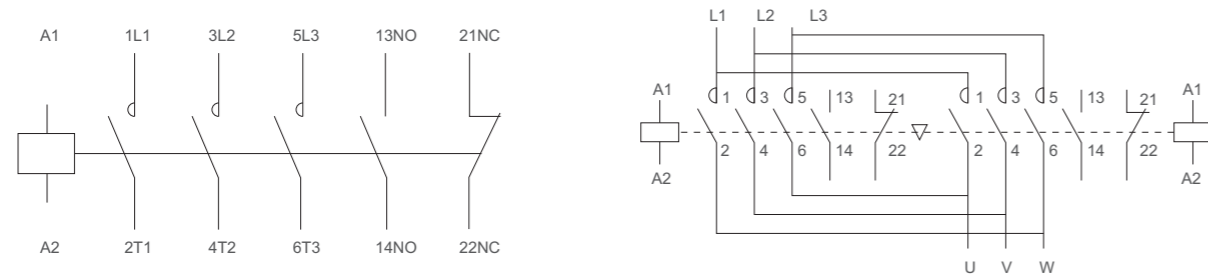

Overall and mounting dimensions

EXC3-06~18

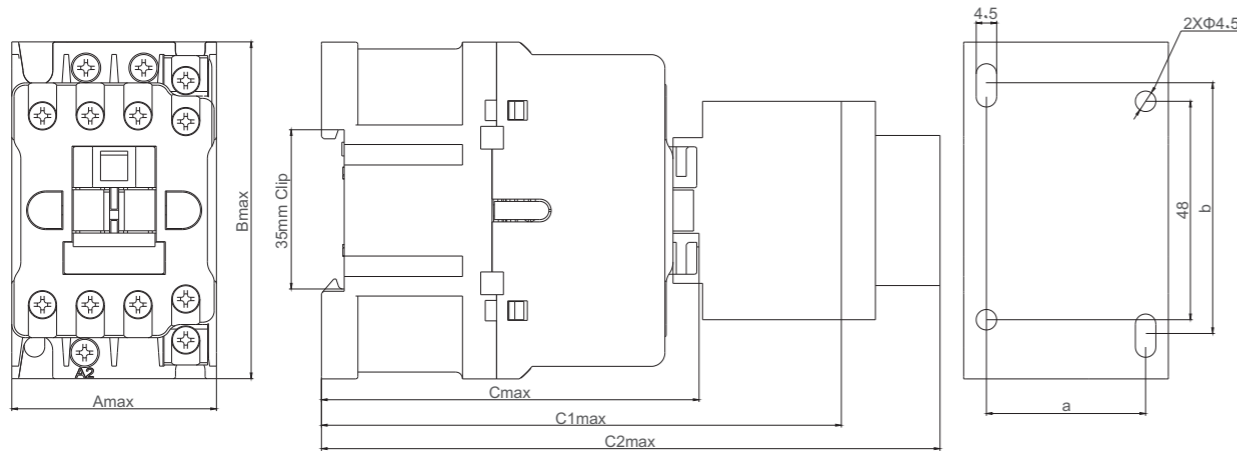

EXC3-25~38

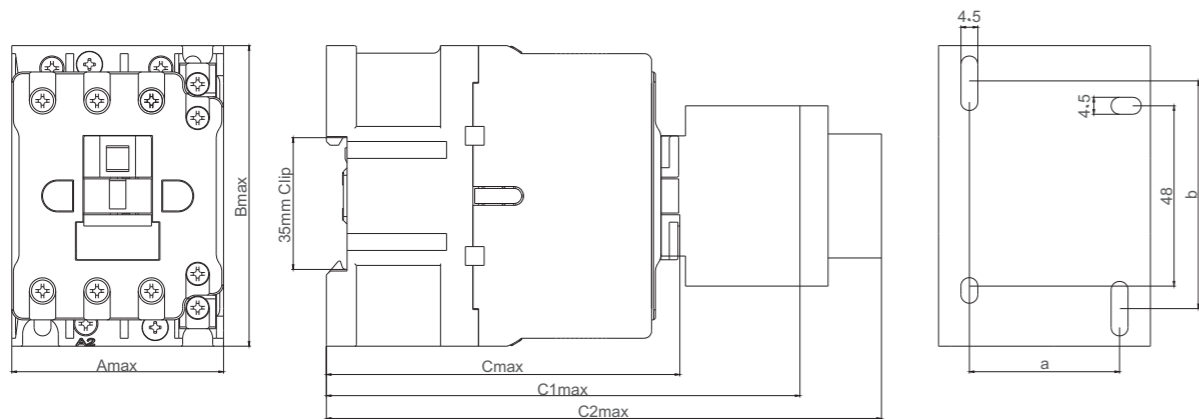

EXC3-40~95

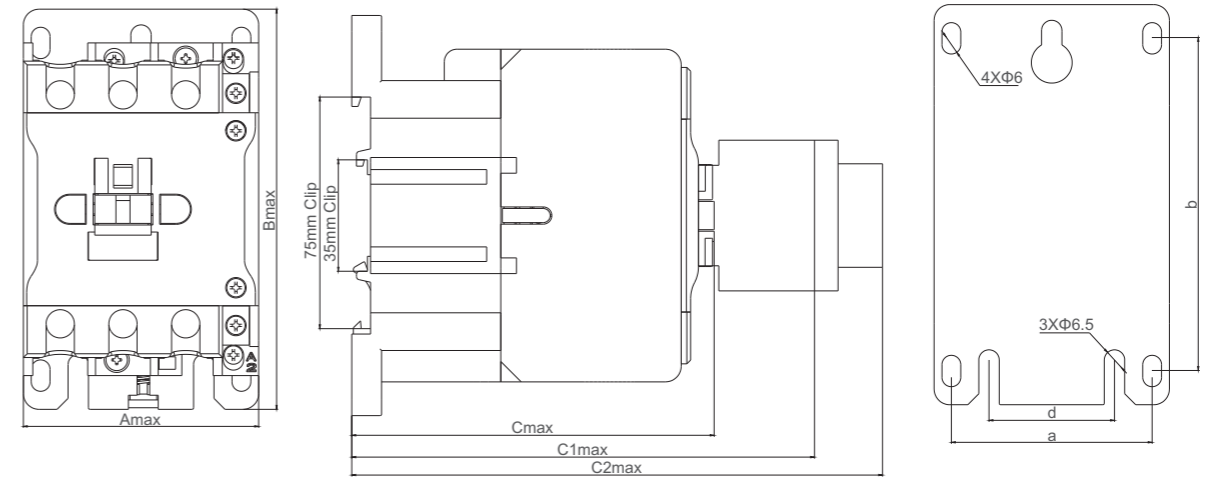

Model	Amax	Bmax	Cmax	C1max	C2max	a	b	d
EXC3-6~18	45.5	74.5	83	115	137	35	50/60	-
EXC3-25~38	56.5	80.5	94.5	127	149	40	50/70	-
EXC3-40~65	75	127.5	116	148	170	64	102/110	40
EXC3-80, 95	85	127.5	118.5	150.5	172.5	64	102/110	40

Note: C1MAX-AC CONTACTOR+F4 C2MAX-AC CONTACTOR+LA2/LA3

EXC3-06~38N

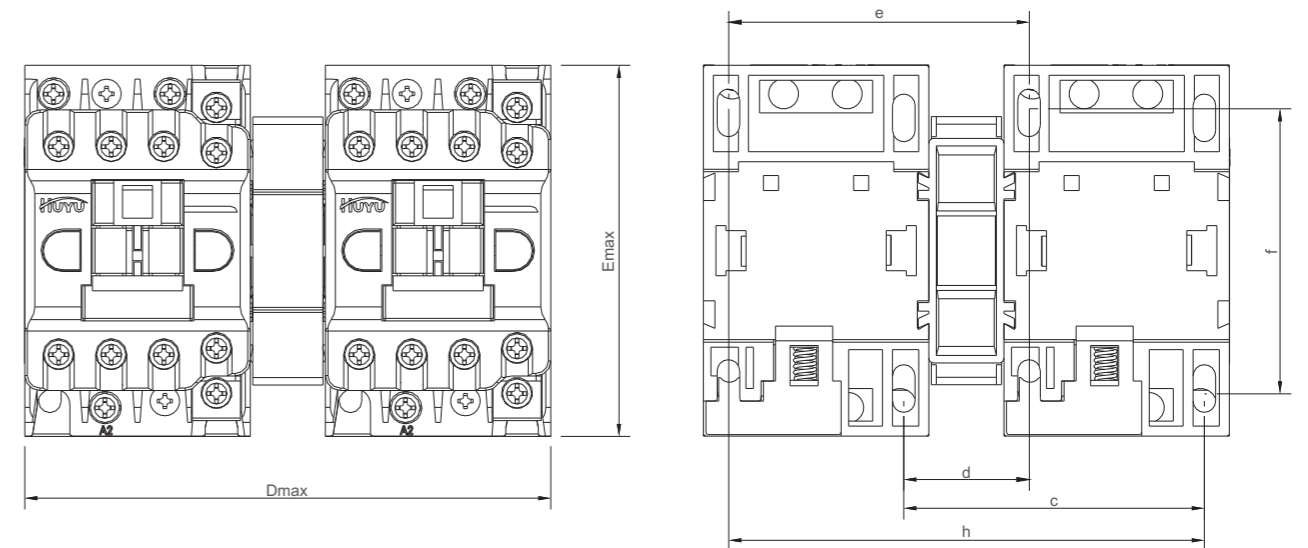

	Dmax	Emax	c	d	e	f	h
EXC3-06N ~ 18N	106	74.5	60.5	25.5	60.5	50/60	95.5
EXC3-25N ~ 38N	128	80.5	72	32	72	50/70	112